

D SERIES
Dismountable Design

TVB-B19

DOUBLE
CONVOLUTION

DRAWING

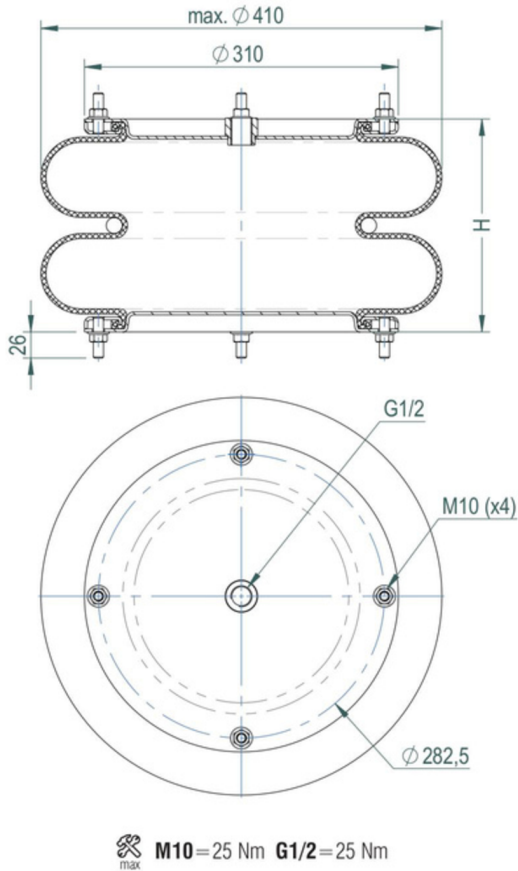

FORCE-HEIGHT CHART

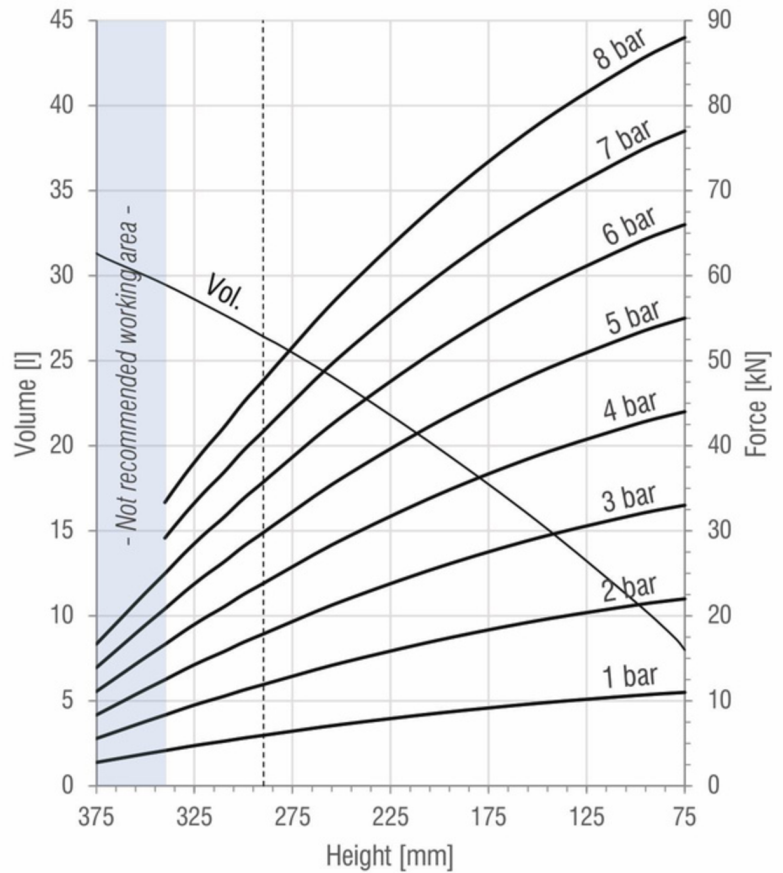

TECHNICAL DATA

PRODUCT CHARACTERISTICS

Static diameter [mm]	400
Max. diameter [mm]	410
Required space diameter [mm]	435
Min. height [mm]	75
Static height [mm]	195
Design height [mm]	290
Max. usable height [mm]	340
Max. stroke [mm]	265
Force to compress to H_{min} at 0 bar [N]	100
Weight [kg]	9,9

REFERENCES

16x2_B	Rubber bellow only
16x2_D	With steel end closures

Designs available with stainless steel and high temperature rubber compounds. Additional designs on request.

DYNAMIC CHARACTERISTICS FOR USE AS ISOLATOR

Pressure [bar]	3	4	5	6	7	Vol. [l]
Load [kN]	17,9	23,8	29,8	35,7	41,7	26,4
Spring rate [N/mm]	177	230	282	334	387	
Natural frequency [Hz]	1,58	1,55	1,54	1,53	1,52	
Isolation rate at 10 Hz	97,5%	97,5%	97,6%	97,6%	97,6%	

Values at recommended design height H: 290 mm - - - -

STATIC CHARACTERISTICS FOR USE AS ACTUATOR

Pressure [bar]	3	4	5	6	7	Vol. [l]	
Height H [mm]	75	33,0	44,0	55,0	66,0	77,0	8,0
	100	31,9	42,5	53,2	63,8	74,4	10,8
	150	29,2	38,9	48,6	58,3	68,0	15,6
	200	25,8	34,3	42,9	51,5	60,1	19,8
	250	21,7	28,9	36,2	43,4	50,6	23,7
	300	16,9	22,5	28,2	33,8	39,4	27,1
350	11,4	15,1	18,9	22,7	-	30,0	

Force values [kN]

All Volume [l] values at 7 bar